

**PLAN VIEW**  
MULTIPLE CONDITIONS

PROJECT NAME: -

PROJECT LOCATION: -

DRAWING DESCRIPTION:

**Wabo®Jeene**

DATE: 12/14/06

MODEL: FW & W



Information provided herein, including but not limited to, any drawing, design, photograph, graphic, or statement(s) ("Materials") are proprietary and the property of Watson Bowman Acme Corporation ("Company"). Reproduction, translation, or reduction to any electronic medium or machine readable form, in whole or part, is strictly prohibited, except for the express purpose for which it has been furnished, without prior written consent of Company. All Materials contained herein are provided by Company for information purposes only. Company reserves the right to amend or withdraw any information contained in the Materials without notice. All technical or other advice by Company, whether verbal or written, concerning products, or the use of products in specific situations ("Advice") is given by Company and is used at the Users own risk.

Watson Bowman Acme Corp.  
95 Pineview Drive Amherst, NY 14228  
phone: (716) 691-7566 fax: (716) 691-9239  
[www.wbacorp.com](http://www.wbacorp.com)



REVISION NO:

-

SHEET NO:

4

DRAWING NO:

C-96011

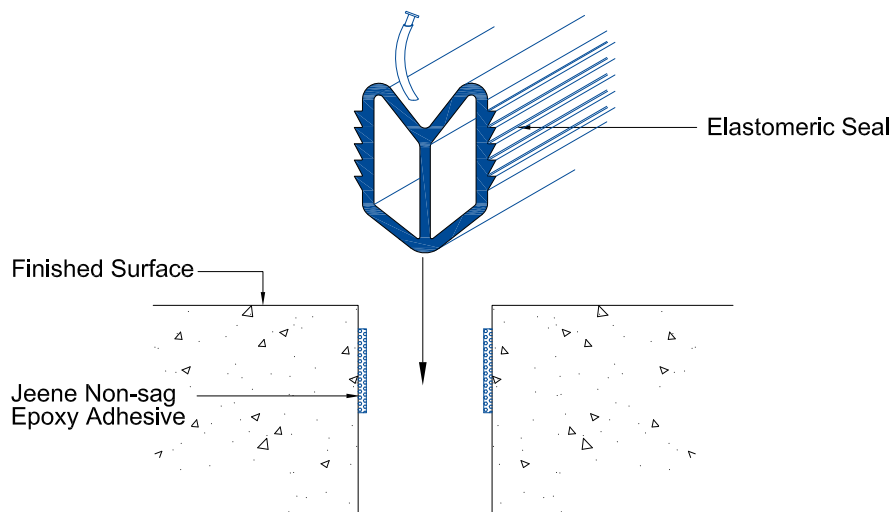

APPLY JEENE® ADHESIVE TO SIDEWALLS AFTER CONTAMINANTS ARE REMOVED BY GRITBLASTING. CLEAN PROFILE WITH JEENE SOLUTION SUPPLIED AND APPLY ADHESIVE TO PROFILE.

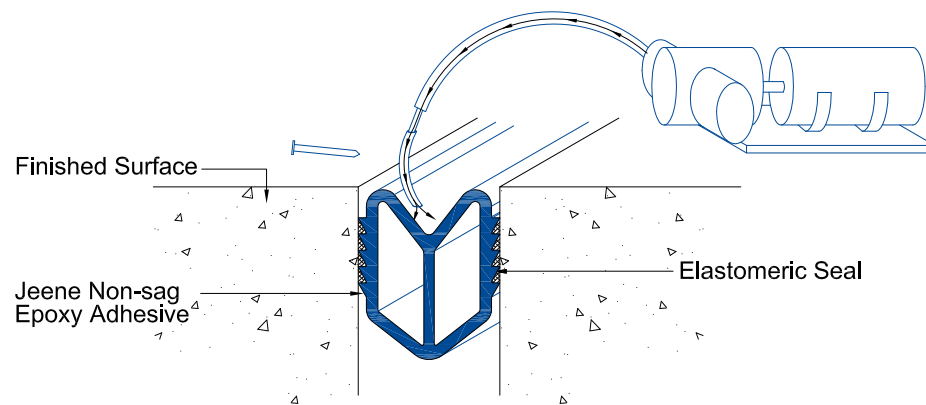

Place Profile Into Joint Gap, Inflate And Remove Excess Adhesive.

### Jeene "W" Profile Shown Jeene "FW" Profile Similar (SLAB-TO-SLAB CONDITION)

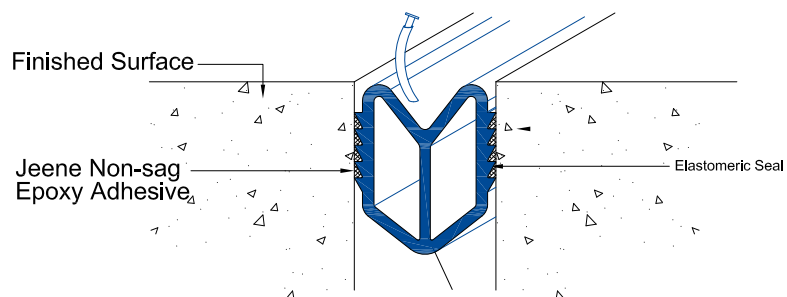

Cap Jeene Seal And Area Will Be Open To Traffic Immediately

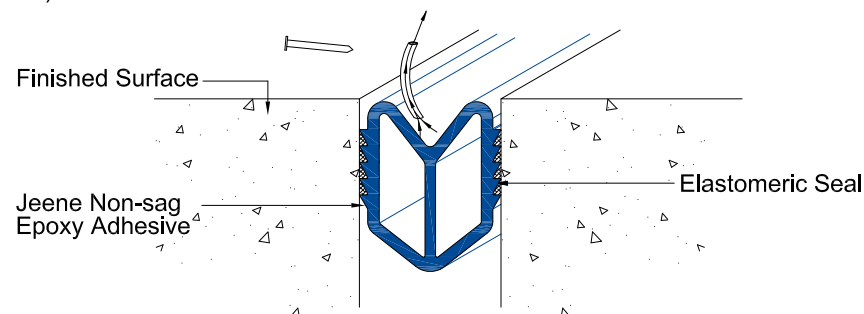

RELEASE AIR FROM PROFILE AFTER 24 HOURS.

PROJECT NAME:	-
PROJECT LOCATION:	-
DRAWING DESCRIPTION:	Wabo®Jeene
DATE: 12/14/06	MODEL: FW-W



Information provided herein, including but not limited to, any drawing, design, photograph, graphic, or statement(s) ("Materials") are proprietary and the property of Watson Bowman Acme Corporation ("Company"). Reproduction, translation, or reduction to any electronic medium or machine readable form, in whole or part, is strictly prohibited, except for the express purpose for which it has been furnished, without prior written consent of Company. All Materials contained herein are provided by Company for information purposes only. Company reserves the right to amend or withdraw any information contained in the Materials without notice. All technical or other advice by Company, whether verbal or written, concerning products, or the use of products in specific situations ("Advice") is given by Company and is used at the Users own risk.

Watson Bowman Acme Corp.  
95 Pineview Drive Amherst, NY 14228  
phone: (716) 691-7566 fax: (716) 691-9239  
www.wbacorp.com



REVISION NO:	-
SHEET NO:	5
DRAWING NO:	C-96011

PLAN VIEW

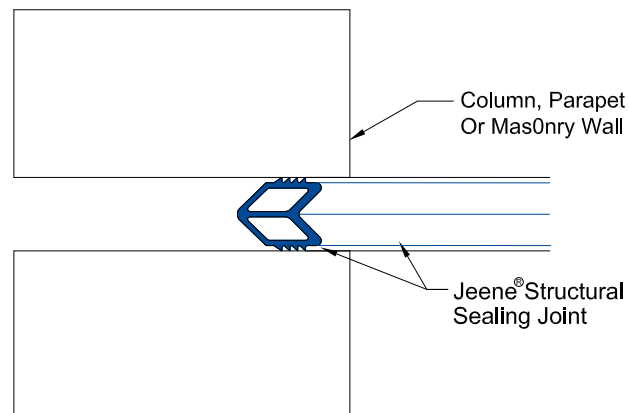

SIDE VIEW

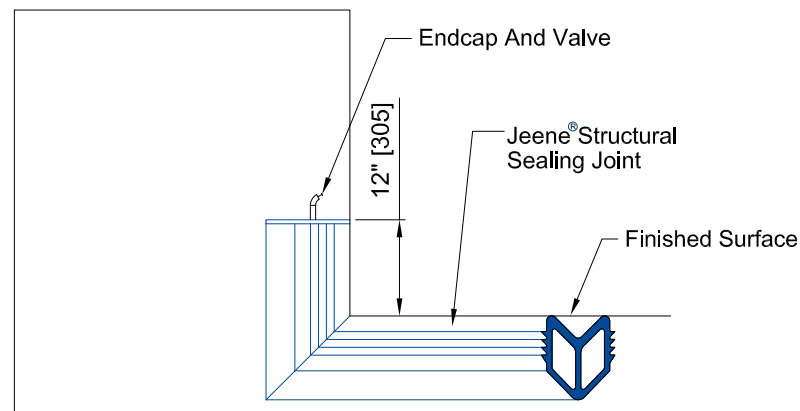

SECTIONAL SIDE VIEW

## JOINT TERMINATION AT SPLIT COLUMN OR PARAPET

Note:  
Jeene® "W" Profile Shown  
Jeene® "FW" Profile Similar

PROJECT NAME:  
-

PROJECT LOCATION:  
-

DRAWING DESCRIPTION:  
  
**Wabo®Jeene**  
  
DATE: 12/14/06  
MODEL: FW-W

**BASF**  
We create chemistry

Watson Bowman Acme Corp.  
95 Pineview Drive Amherst, NY 14228  
phone: (716) 691-7566 fax: (716) 691-9239  
www.wbacorp.com

**Watson  
Bowman  
Acme**

Information provided herein, including but not limited to, any drawing, design, photograph, graphic, or statement(s) ("Materials") are proprietary and the property of Watson Bowman Acme Corporation ("Company"). Reproduction, translation, or reduction to any electronic medium or machine readable form, in whole or part, is strictly prohibited, except for the express purpose for which it has been furnished, without prior written consent of Company. All Materials contained herein are provided by Company for information purposes only. Company reserves the right to amend or withdraw any information contained in the Materials without notice. All technical or other advice by Company, whether verbal or written, concerning products, or the use of products in specific situations ("Advice") is given by Company and is used at the Users own risk.

REVISION NO:  
-

SHEET NO:  
6

DRAWING NO:  
C-96011

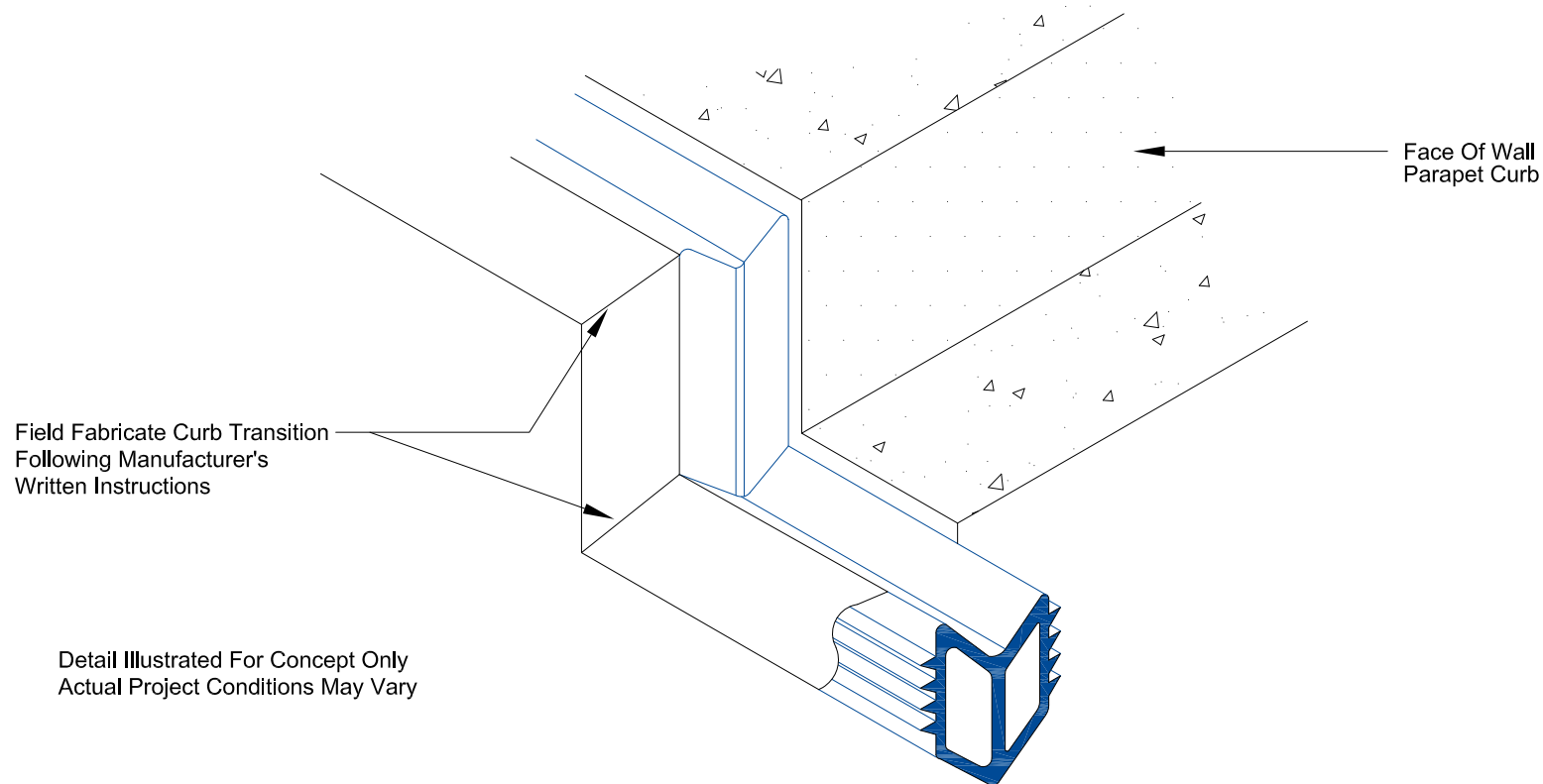

## 90° MITERED JEENE DETAIL

Jeene® "W" Profile Shown  
Jeene® "FW" Profile Similar

PROJECT NAME:  
-

PROJECT LOCATION:  
-

DRAWING DESCRIPTION:

**Wabo®Jeene**

DATE: 12/14/06

MODEL: FW & W



Information provided herein, including but not limited to, any drawing, design, photograph, graphic, or statement(s) ("Materials") are proprietary and the property of Watson Bowman Acme Corporation ("Company"). Reproduction, translation, or reduction to any electronic medium or machine readable form, in whole or part, is strictly prohibited, except for the express purpose for which it has been furnished, without prior written consent of Company. All Materials contained herein are provided by Company for information purposes only. Company reserves the right to amend or withdraw any information contained in the Materials without notice. All technical or other advice by Company, whether verbal or written, concerning products, or the use of products in specific situations ("Advice") is given by Company and is used at the Users own risk.

Watson Bowman Acme Corp.  
95 Pineview Drive Amherst, NY 14228  
phone: (716) 691-7566 fax: (716) 691-9239  
[www.wbacorp.com](http://www.wbacorp.com)



REVISION NO:

-

SHEET NO:

7

DRAWING NO:

C-96011

Field Fabrication Expansion Joint  
Transition Following Manufacturer's  
Written Instructions

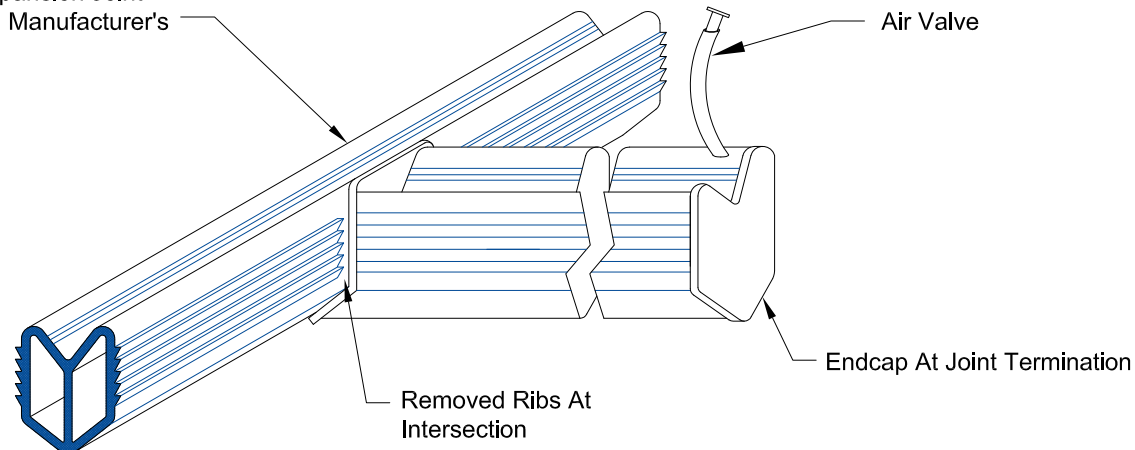

## JOINT 3-WAY INTERSECTION ISOMETRIC

"T" SECTION SPLICE DETAIL  
Jeene® "W" Profile Shown  
Jeene® "FW" Profile Similar

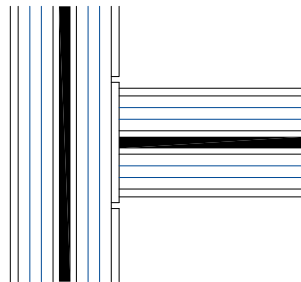

## JOINT 3-WAY INTERSECTION PLAN

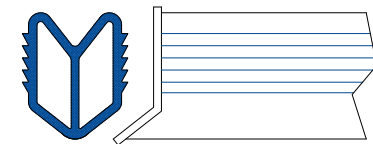

## JOINT INTERSECTION PRIOR TO ASSEMBLY

PROJECT NAME:  
-

PROJECT LOCATION:  
-

DRAWING DESCRIPTION:

Wabo®Jeene

DATE: 12/14/06

MODEL: FW & W



Watson Bowman Acme Corp.  
95 Pineview Drive Amherst, NY 14228  
phone: (716) 691-7566 fax: (716) 691-9239  
[www.wbacorp.com](http://www.wbacorp.com)



Information provided herein, including but not limited to, any drawing, design, photograph, graphic, or statement(s) ("Materials") are proprietary and the property of Watson Bowman Acme Corporation ("Company"). Reproduction, translation, or reduction to any electronic medium or machine readable form, in whole or part, is strictly prohibited, except for the express purpose for which it has been furnished, without prior written consent of Company. All Materials contained herein are provided by Company for information purposes only. Company reserves the right to amend or withdraw any information contained in the Materials without notice. All technical or other advice by Company, whether verbal or written, concerning products, or the use of products in specific situations ("Advice") is given by Company and is used at the Users own risk.

REVISION NO:  
-

SHEET NO:  
8

DRAWING NO:  
C-96011

Field Fabrication Expansion Joint  
Transition Following Manufacturer's  
Written Instructions

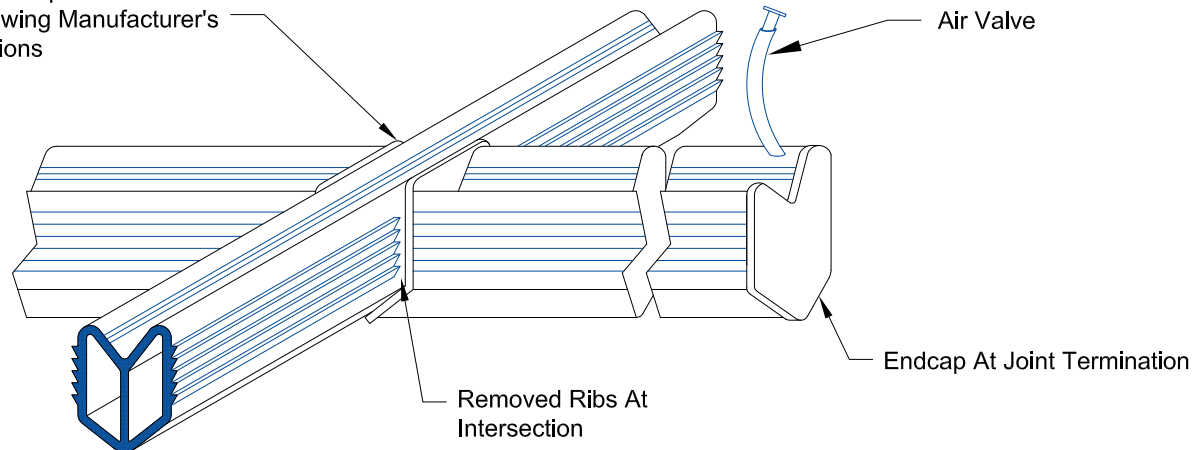

## JOINT 4-WAY INTERSECTION ISOMETRIC

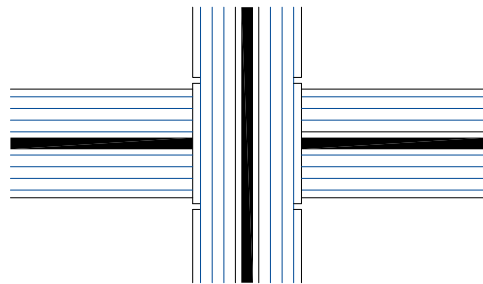

## JOINT 4-WAY INTERSECTION PLAN

"X" SECTION SPLICE DETAIL  
Jeene® "W" Profile Shown  
Jeene® "FW" Profile Similar

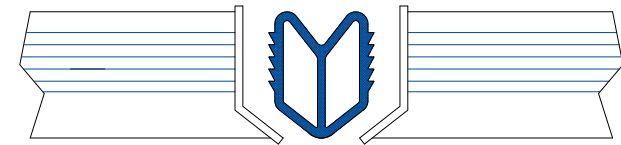

## JOINT INTERSECTION PRIOR TO ASSEMBLY

PROJECT NAME:  
-

PROJECT LOCATION:  
-

DRAWING DESCRIPTION:

Wabo®Jeene

DATE: 12/14/06

MODEL: FW & W



Watson Bowman Acme Corp.  
95 Pineview Drive Amherst, NY 14228  
phone: (716) 691-7566 fax: (716) 691-9239  
[www.wbacorp.com](http://www.wbacorp.com)



Information provided herein, including but not limited to, any drawing, design, photograph, graphic, or statement(s) ("Materials") are proprietary and the property of Watson Bowman Acme Corporation ("Company"). Reproduction, translation, or reduction to any electronic medium or machine readable form, in whole or part, is strictly prohibited, except for the express purpose for which it has been furnished, without prior written consent of Company. All Materials contained herein are provided by Company for information purposes only. Company reserves the right to amend or withdraw any information contained in the Materials without notice. All technical or other advice by Company, whether verbal or written, concerning products, or the use of products in specific situations ("Advice") is given by Company and is used at the Users own risk.

REVISION NO:  
-

SHEET NO:  
9

DRAWING NO:  
C-96011